

Brightlands Chemelot Campus welcomes



March 30, 2017

Brightlands
Chemelot Campus

Brightlands

Introduction to Brightlands Chemelot Campus

1. What is Brightlands Chemelot Campus?
2. Unique strengths
3. How do we grow?
4. Key Success Factors

Brightlands

What is Chemelot?

- One of the largest chemical and material communities in Europe (ca 8 km²)
- Industrial Park + Campus
- Number of companies on site > 150; strongly growing since 2005

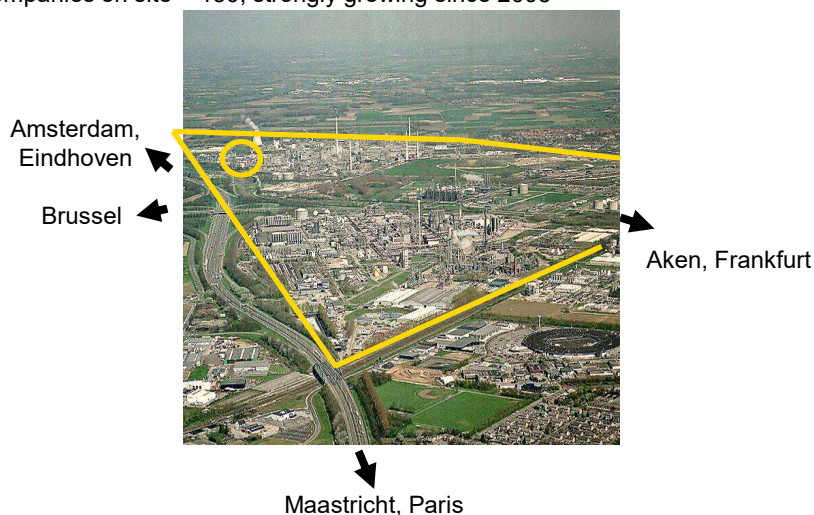

Brightlands

Chemelot: 100+ Years of Chemical and Performance Materials development

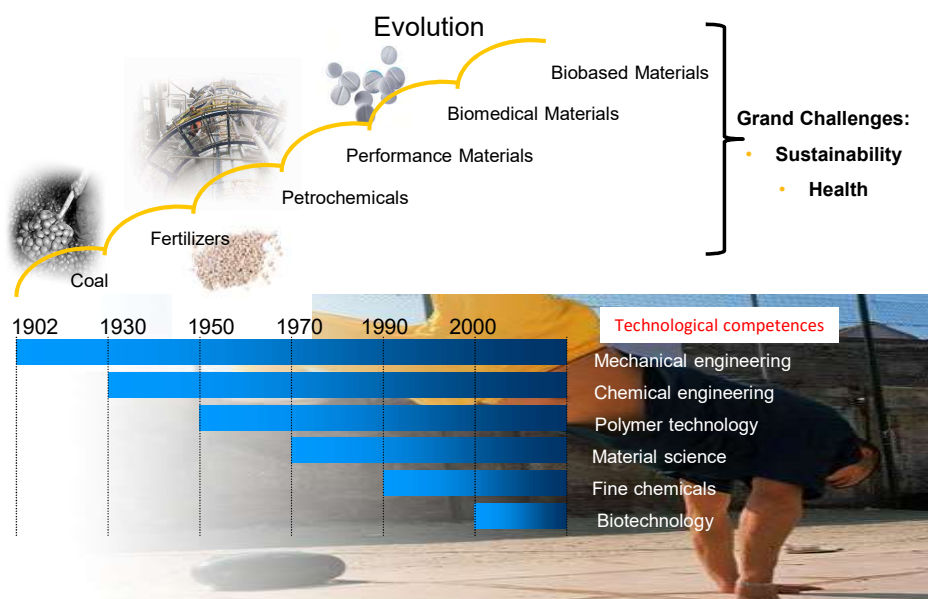

Brightlands

Triple Helix Ownership

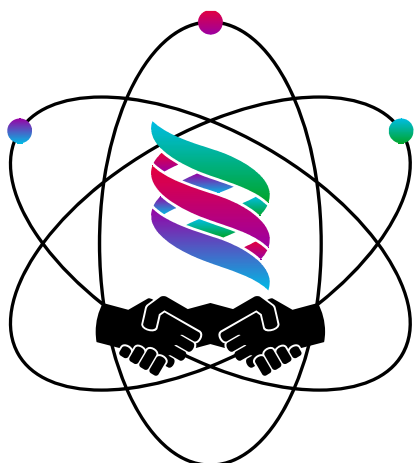

Partners:

Government

provincie limburg 

Knowledge Institute

 Maastricht University

Industry

 **DSM**
BRIGHT SCIENCE. BRIGHTER LIVING.

Brightlands

Brightlands Chemelot Campus: focus

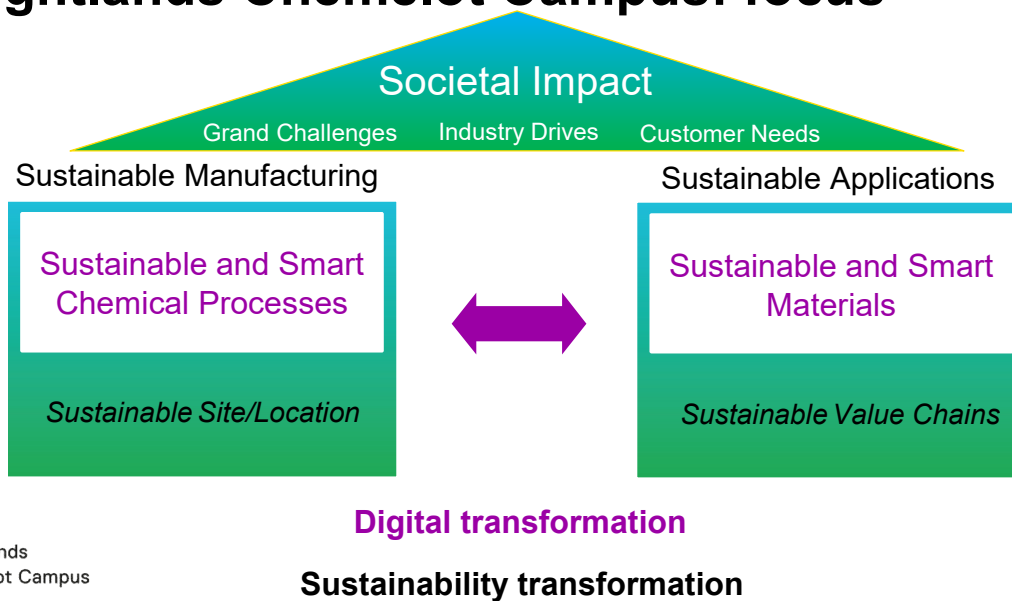

Brightlands

Brightlands Chemelot Campus: focus

strategic choices based on unique strengths

Sustainable Chemical Processes	Sustainable Materials
Topics: Advanced Chemistry Biobased processes Electrification Electrochemistry Scalability	Topics: 3D printing Leight Weight (Automotive) Smart / specialty packaging Smart / sustainable buildings Coatings Biobased materials Cell Therapy/Biomedical Materials

Brightlands
Chemelot Campus

Brightlands

Strategy: Grow, Grow, Grow!

Knowledgeworkers



Students



Companies



	Knowledgeworkers	Students	Companies
2005	900	0	4
2016	1.920	650	80+
2023	2.900	1.000	>100

Well filled
pipeline with
300+ growth
opportunities

8 Brightlands
Chemelot Campus

Brightlands

Brightlands Chemelot Campus

How do we grow?

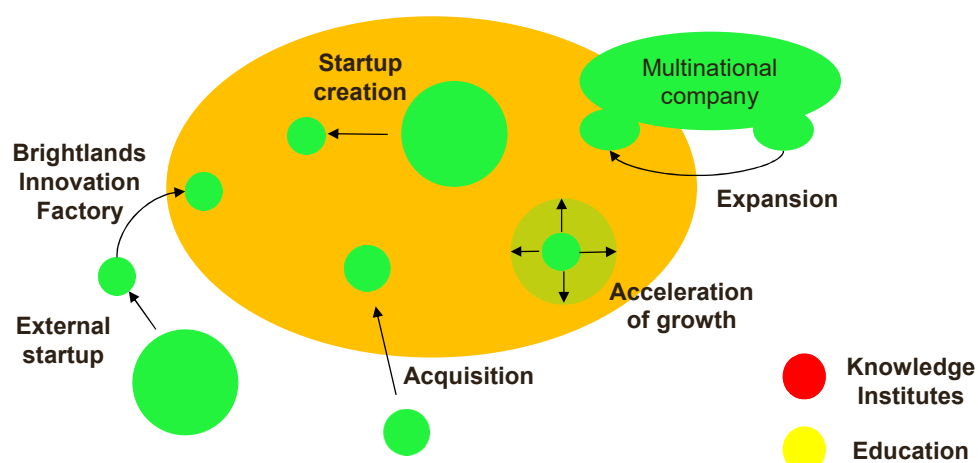
 $1 + 1 > 3$

Campus Key Success Factors

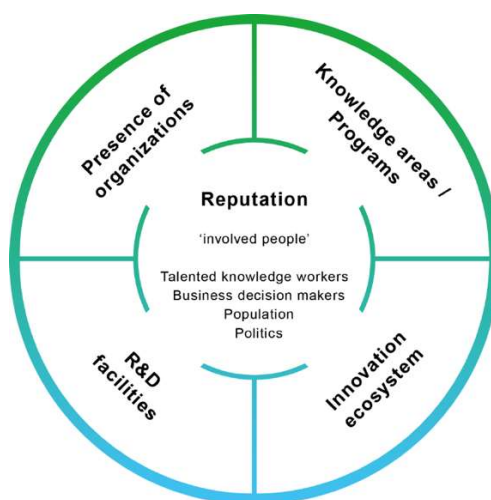

Top Science and Innovation Parks

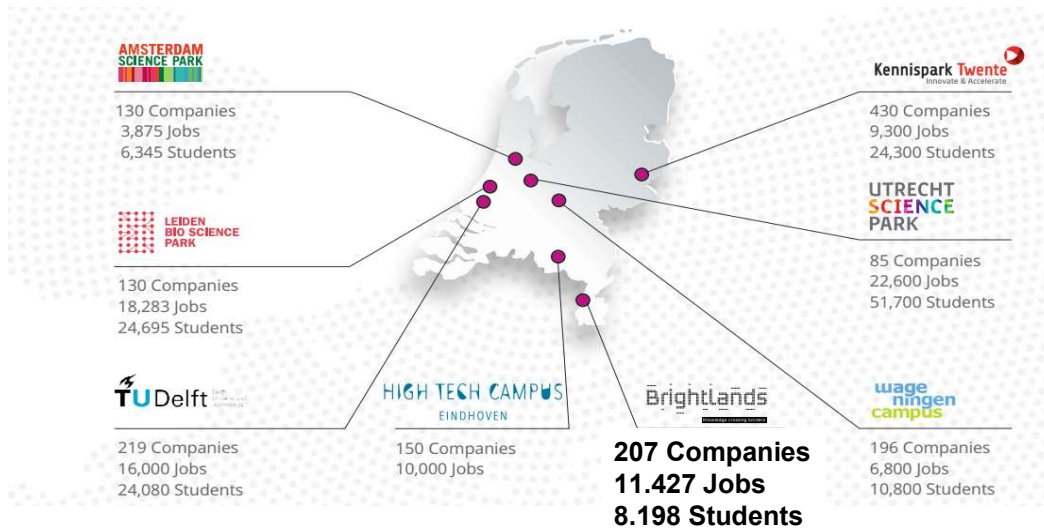

Brightlands

Campus Key Success Factors

Knowledge Intensive Organisations:

- Corporates
- SMEs
- Startups
- Education Institutes
- Scientific Centers

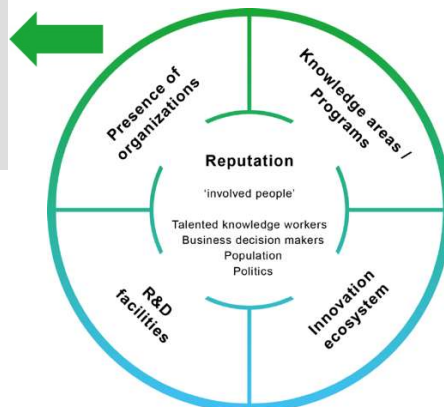

Unique knowledge and global networks



Corporates



Startups



SMEs



Education Partners



Scientific Centers



Brightlands

Global leading valuechains



Brightlands

Campus Key Success Factors

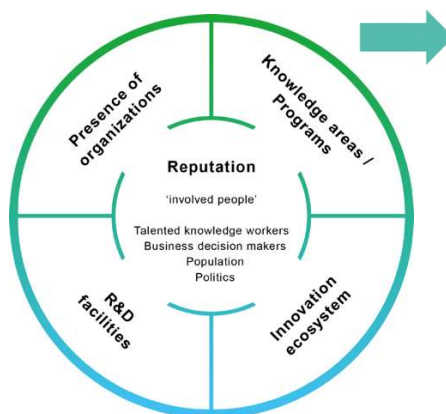

Development of unique knowledge in Public-Private Partnerships

- Performance Materials
- Biomedical
- Biobased
- Enabling Technologies

Brightlands Knowledge Chains



Scientific Disciplines
Chemistry, Biologics,
Analytics, Physics

Technology Platforms:
Adhesion, Barrier Properties,
Optics, Esthetics

Knowledge underlying pro-
duction, commercialisation
(kitchen & trade secrets)

Mostly at uni's

R&D Centers

Industry Organisations

Precompetitive PPS

Shared PPS, Industry R&D

Closed R&D

Brightlands

Public Private Knowledge Institutes

Brightlands Chemelot Campus

Brightlands Maastricht Health Campus

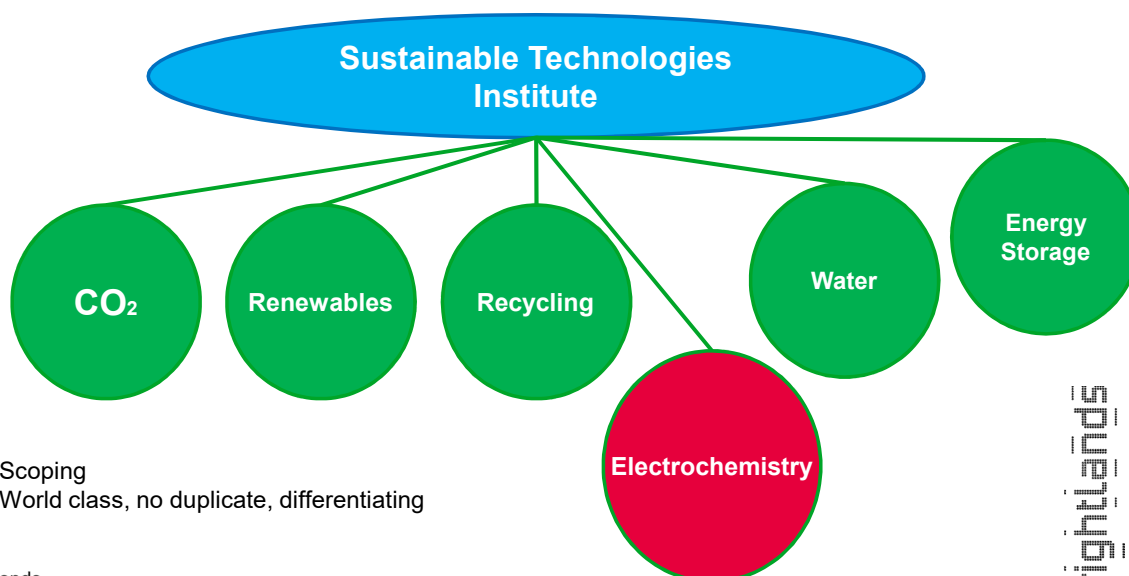
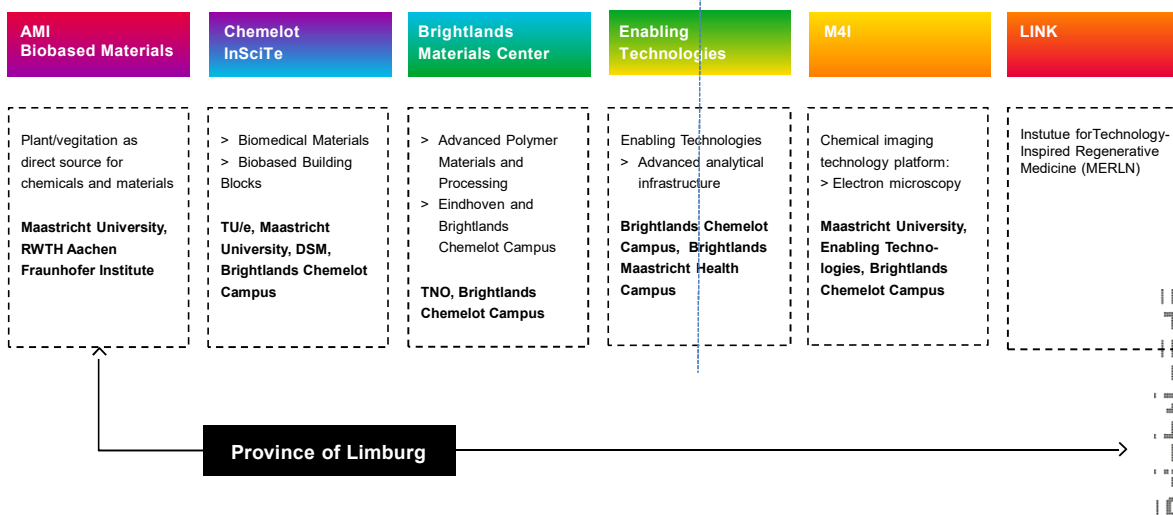

Brightlands
Chemelot Campus

Open innovation ecosystem

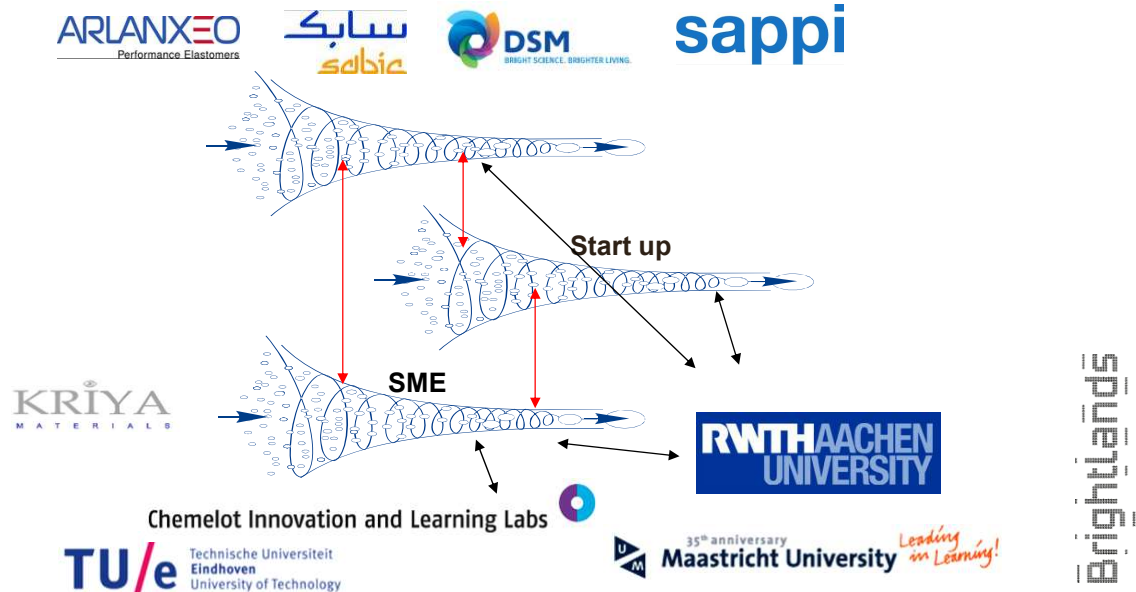

Campus Key Success Factors

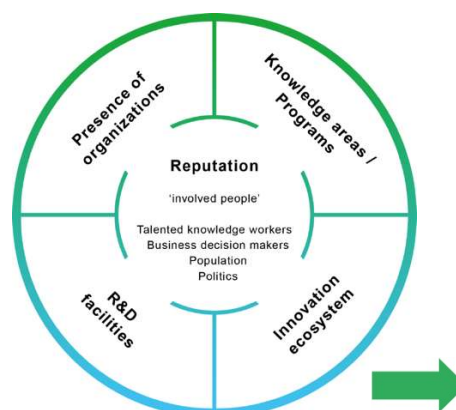

Innovation Ecosystem

- Talent development
- Campus community development
- Quality of Life



Open Innovation = people working together

21

Brightlands

CHAMPIONS LEAGUE



Leading Organisations
&
Top Talents



Brightlands

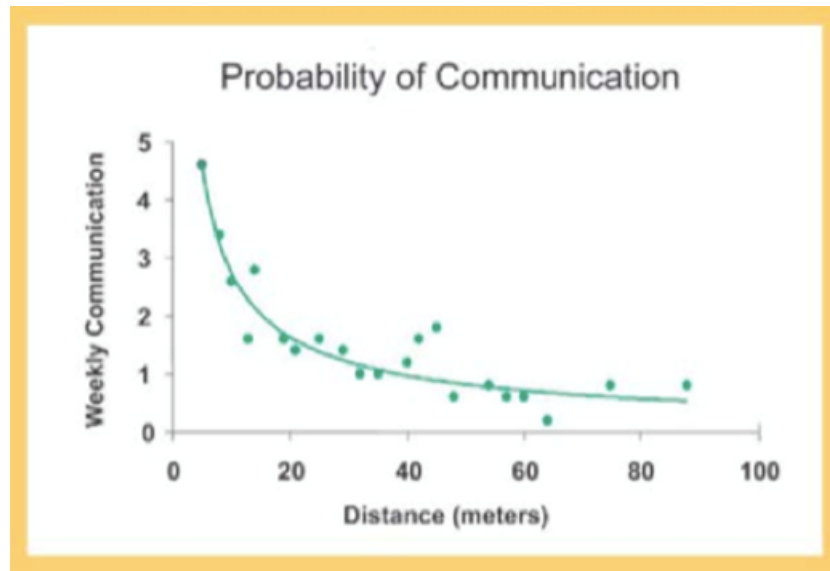

Community Development

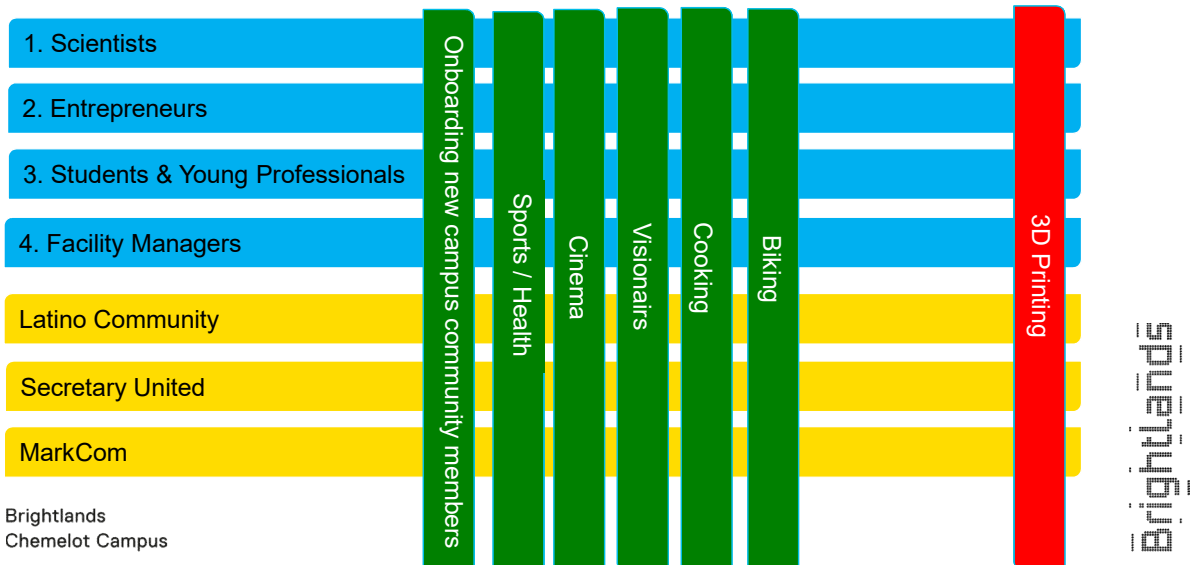

Talent development

- Unique combination of educational organizations, industries and knowledge institutes
- Located in the center of a strong international knowledge network
- Attractive working environment with global business networks
- Full career perspective in region (business & scientific)
- Education near industry: real-life cases from industry via Chemelot Innovation and Learning Labs (CHILL)
- Internationally recognized problem-based learning education system of Maastricht University



Brightlands

Campus Key Success Factors

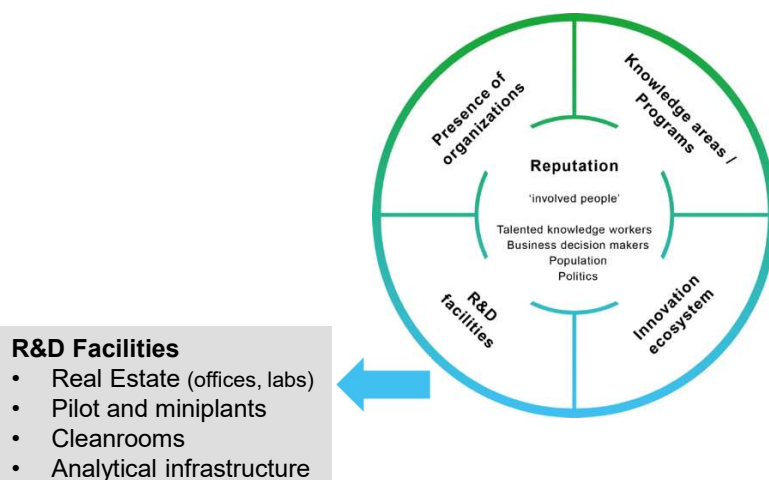

R&D Facilities

- Laboratoria, Offices
- Enabling Technologies
- Pilot & Mini Plant Facilities
Cleanrooms

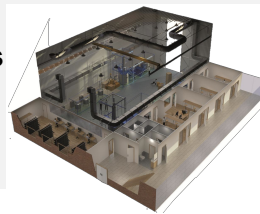

Brightlands

LANXESS HQ – 2013 (Single tenant)

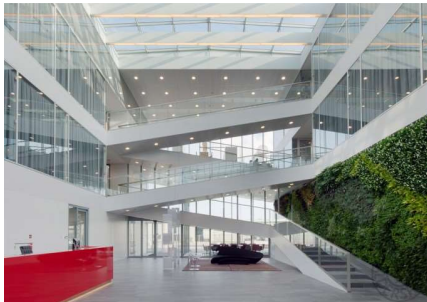

Brightlands

DSM Materials Center - 2014



Brightlands

DSM Materials Center - 2014



Brightlands

SABIC - 2015 / 2016



Brightlands

Center Court – 2016 central facilities, multi-tenant



- Restaurant, conference rooms, sports facilities and shops
- Meeting place for campus workers
- Helping to attract knowledge workers and students
- Serving as a stylish venue to host external visitors
- Facilities to host international scientific conferences.

Brightlands

Speeding up product development process by professional pilot & mini-plant facilities

- Dedicated state-of-the-art pilot plant infrastructure benefitting of the adjacent position of Chemelot Industrial Park (broad spectrum utilities and services, industrial waste water treatment, waste handling, safety, security, fire brigade, logistics);
- Central Raw Material Purification Unit offering purified ethylene and propylene;
- 24/7 Central site management (work permits, safety monitoring, duty officer, etc.)
- Multi-purpose pilot plant for chemical process development / scale up
- Technical infrastructure enabling fast accommodation of new pilot plants already in place

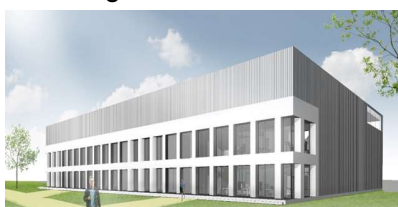

Brightlands



Campus Key Success Factors

Unique knowledge and global networks



R&D Facilities

- Laboratoria, Offices
- Enabling Technologies
- Pilot & Mini Plant Facilities



High-end Analytical facilities

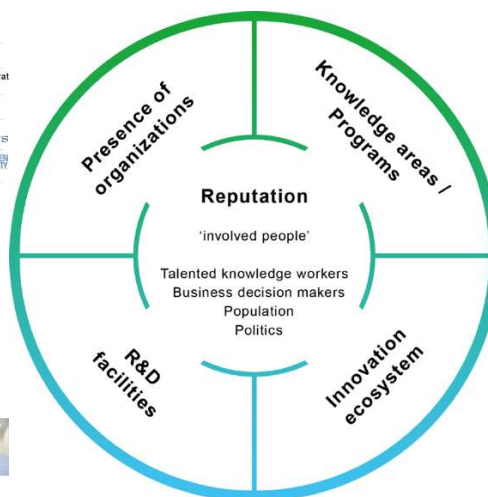

Knowledge areas – Programs

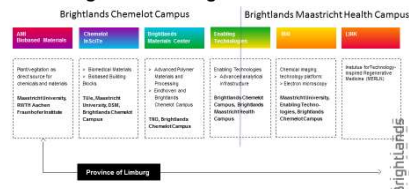

Knowledge Crossing Borders

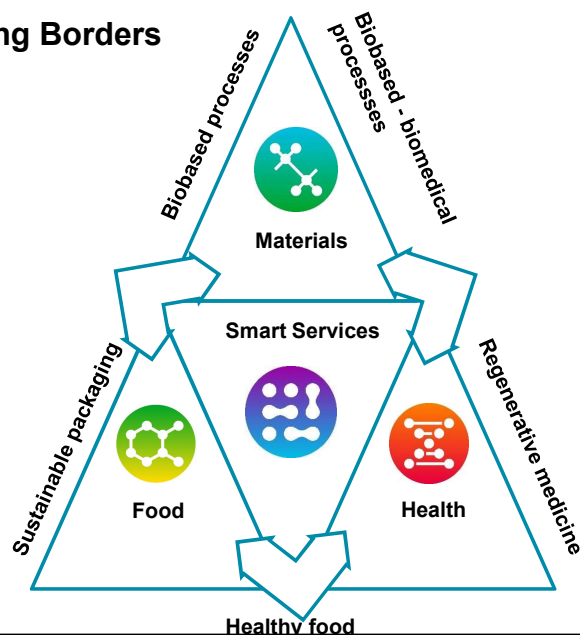

Brightlands

Brightlands Chemelot Campus, the place to be for winners in chemistry and materials



frank.schaap@brightlands.com

06-20 44 67 62

Brightlands
Chemelot Campus

Brightlands